

1. New two storey classroom block providing an additional 3 classrooms
2. Classroom converted back to IT suite
3. Classroom converted to staff work space and intervention room
4. Boys wcs refurbished and new corridor access to rear
5. Additional car parking for staff to accommodate increased staff numbers
6. Existing entrance to be utilised for car park entrance
7. Existing footpath widened to allow two way flow of pedestrians removing need to walk through car park
8. Car park reduced in numbers to accommodate wider footpath
9. Studio Extension to hall
10. Existing area of soft play area to be resurfaced with astro turf
11. External canopies relocated
12. Cabin relocated to courtyard
13. Landscape screen

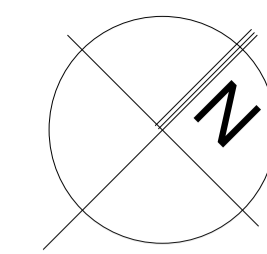

© Bowker Sadler Partnership Limited
 This drawing is the subject of copyright which vests in Bowker Sadler Partnership Limited. It is an infringement of copyright to reproduce this drawing, by whatever means, including electronic, without the express written consent of Bowker Sadler Partnership Limited which reserves all its rights.
 Bowker Sadler Partnership Limited asserts its rights to be identified as the author of this design.

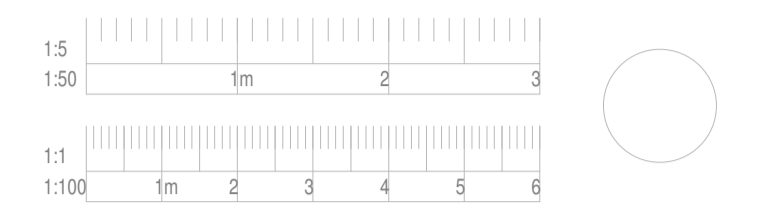

- Site Access Key**
- Boundary Fencing
 - Vehicular Access Point
 - Pedestrian Access Point

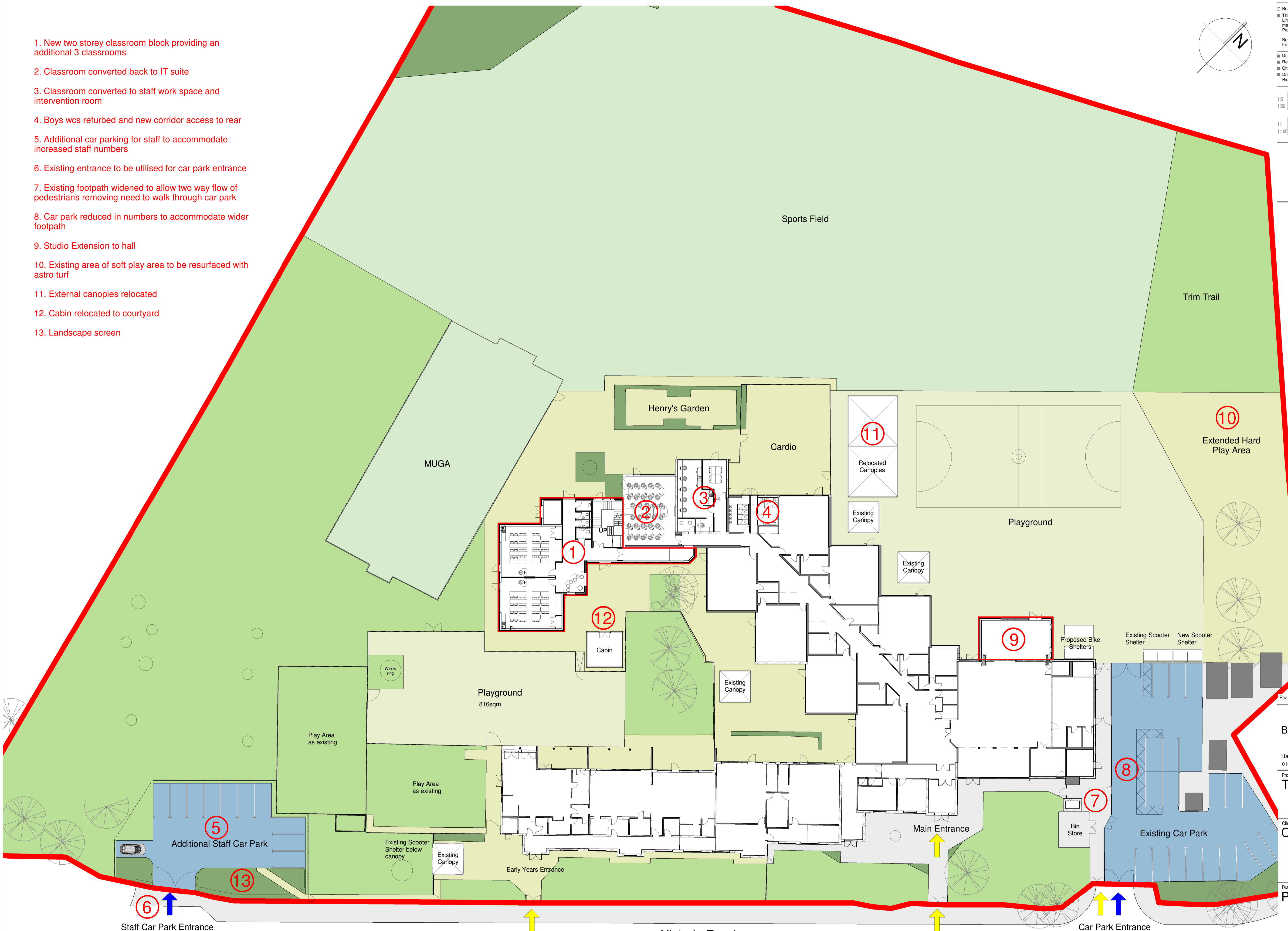

Rev.	Date	Dr.	Chkd.

BOWKER SADLER ARCHITECTURE

Hatherlow House | Hatherlow | Romiley | Stockport | SK6 3DY
 0161 406 7333 | office@bowker-sadler.co.uk | www.bowker-sadler.co.uk

Project
The Willows Primary School

Client
Conlon Construction Ltd

Drawing
Proposed Site Plan

Site Plan - Proposed Plan
 1 : 250

Scale	Sheet Size	Drawn	Checked	Date		
As indicated	@ A1	AT	AC	03/22		
Project No.	Originator	Zone	Level	Form Discipline	Number	Revision
21-055 -						1101
Status	Comment					

I:\projects\21-055\21-055-1101\21-055-1101-01.dwg